

INDICE REVISIONI - REVISION HISTORY			
REV.	DESCRIZIONE - DESCRIPTION	DATA - DATE	APPR.
0	MODIFICATA FLANGIA PORTA BREAKER	17/10/2017	ADM
0	AUMENTATA TOLLERANZA CENTRAGGIO INGRESSO E USCITA	07/11/2017	ADM
1	SOSTITUITE RESISTENZE CON MODELLO AGGIORNATO	16/11/2017	ADM
1	AGGIUNTA ASTA ESTRAZIONE	18/12/17	ADM

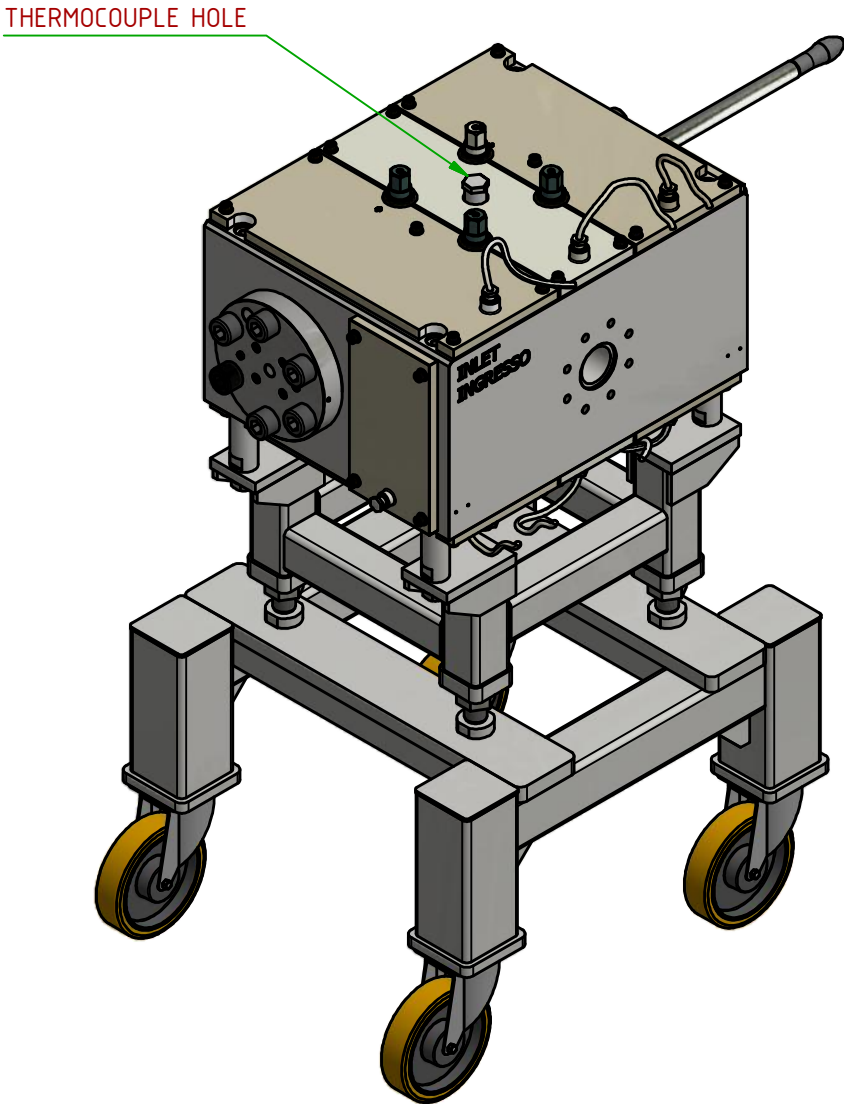
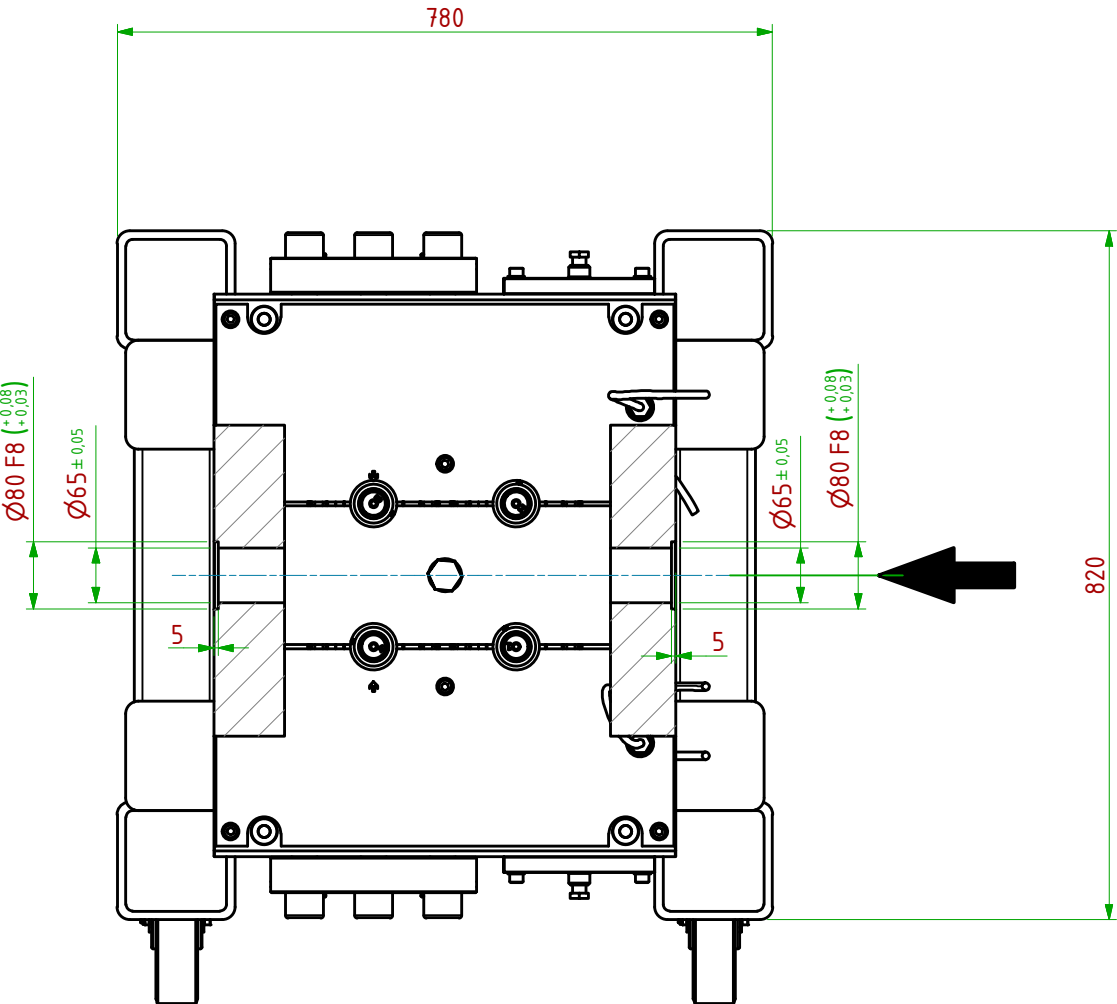
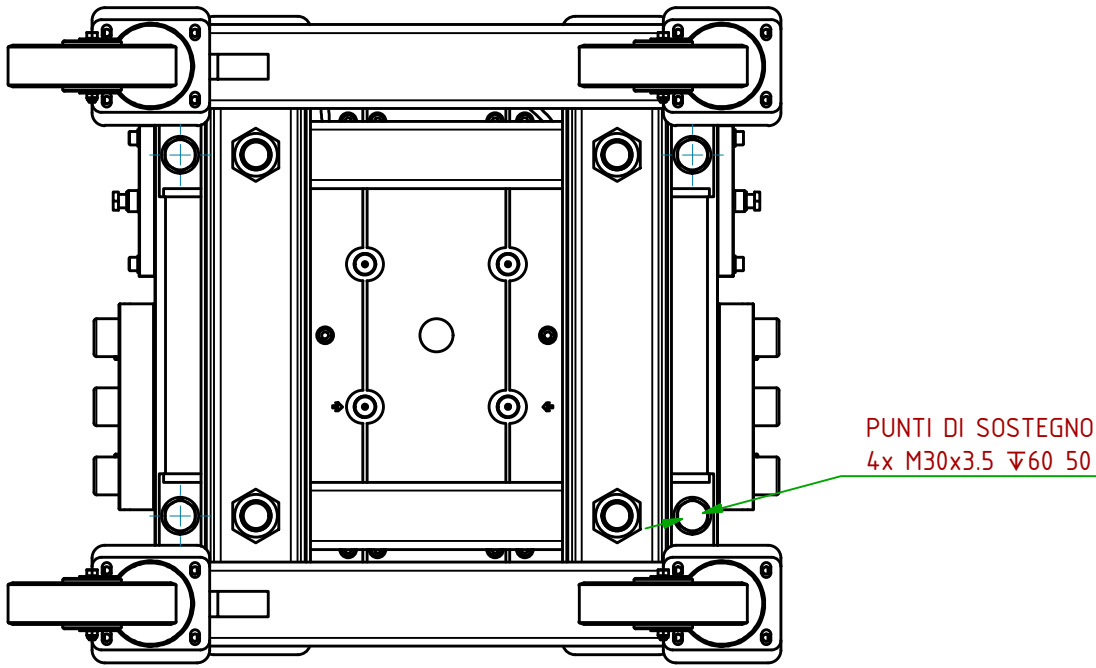
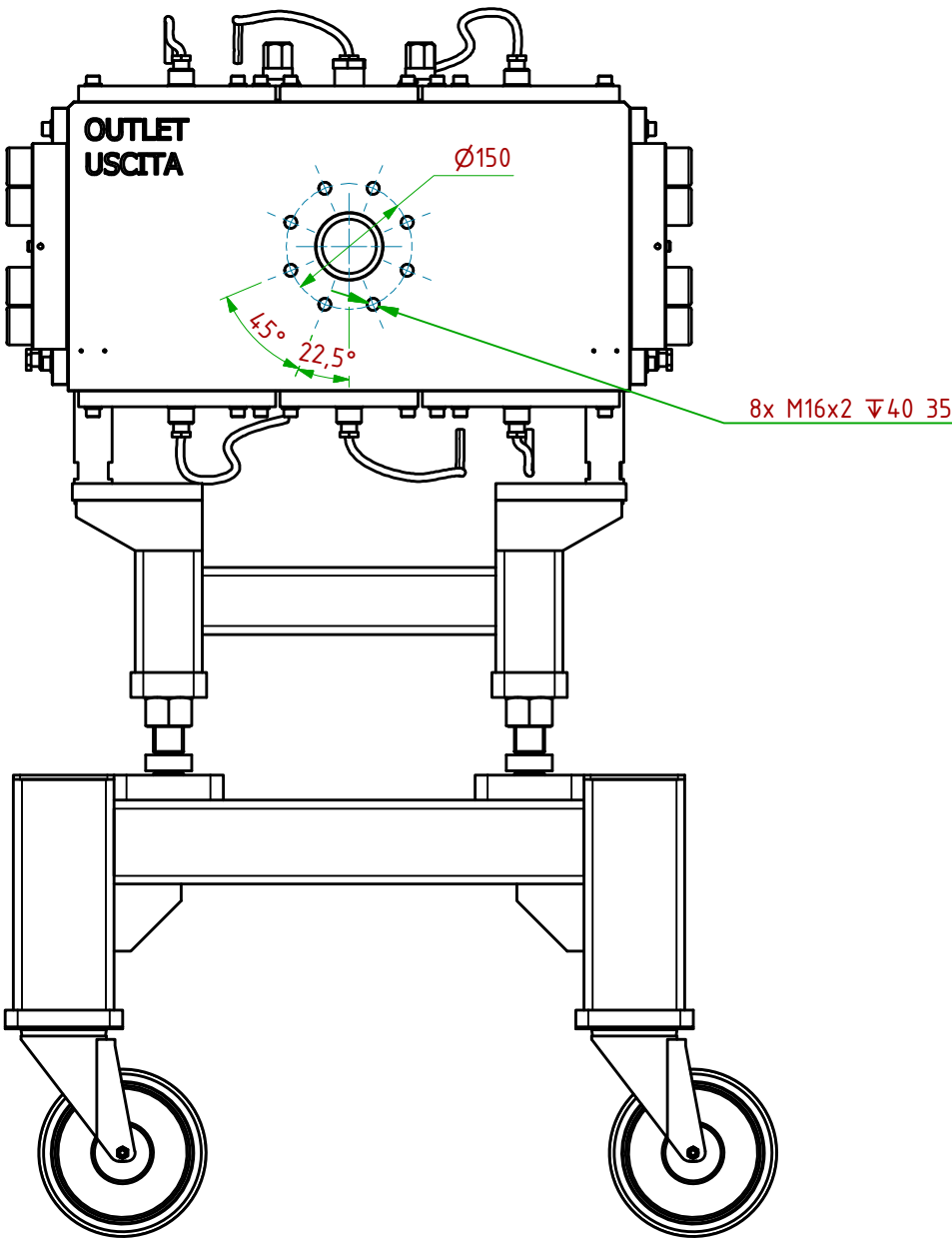
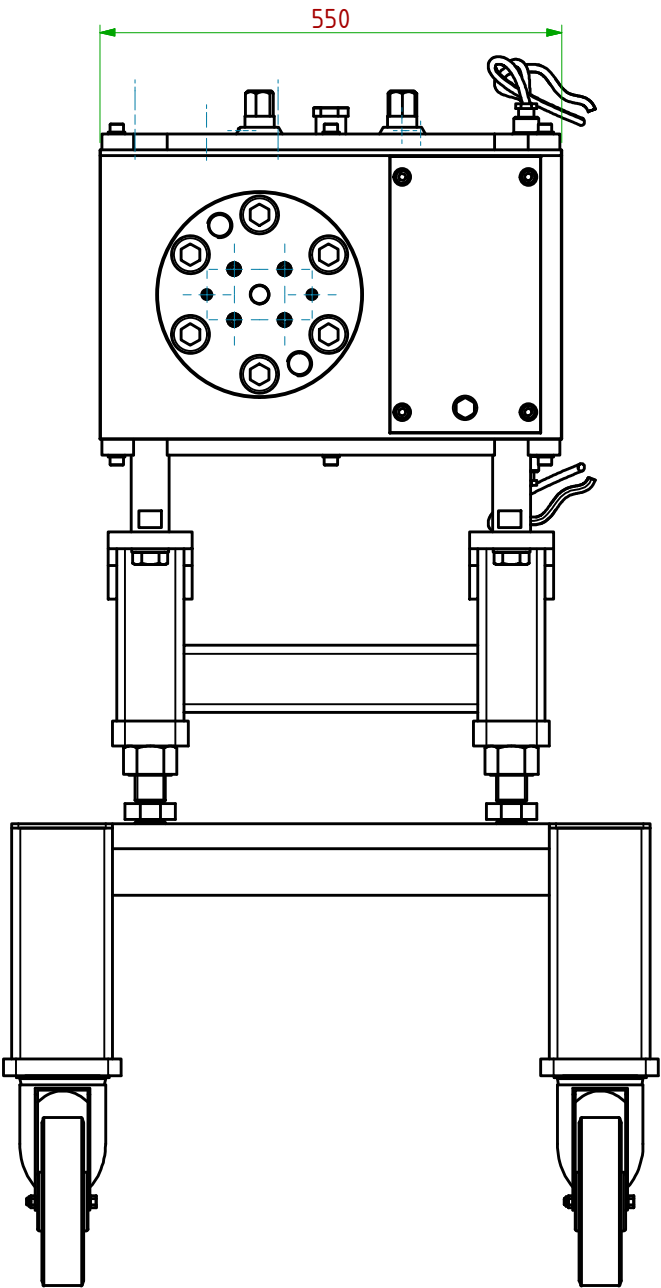
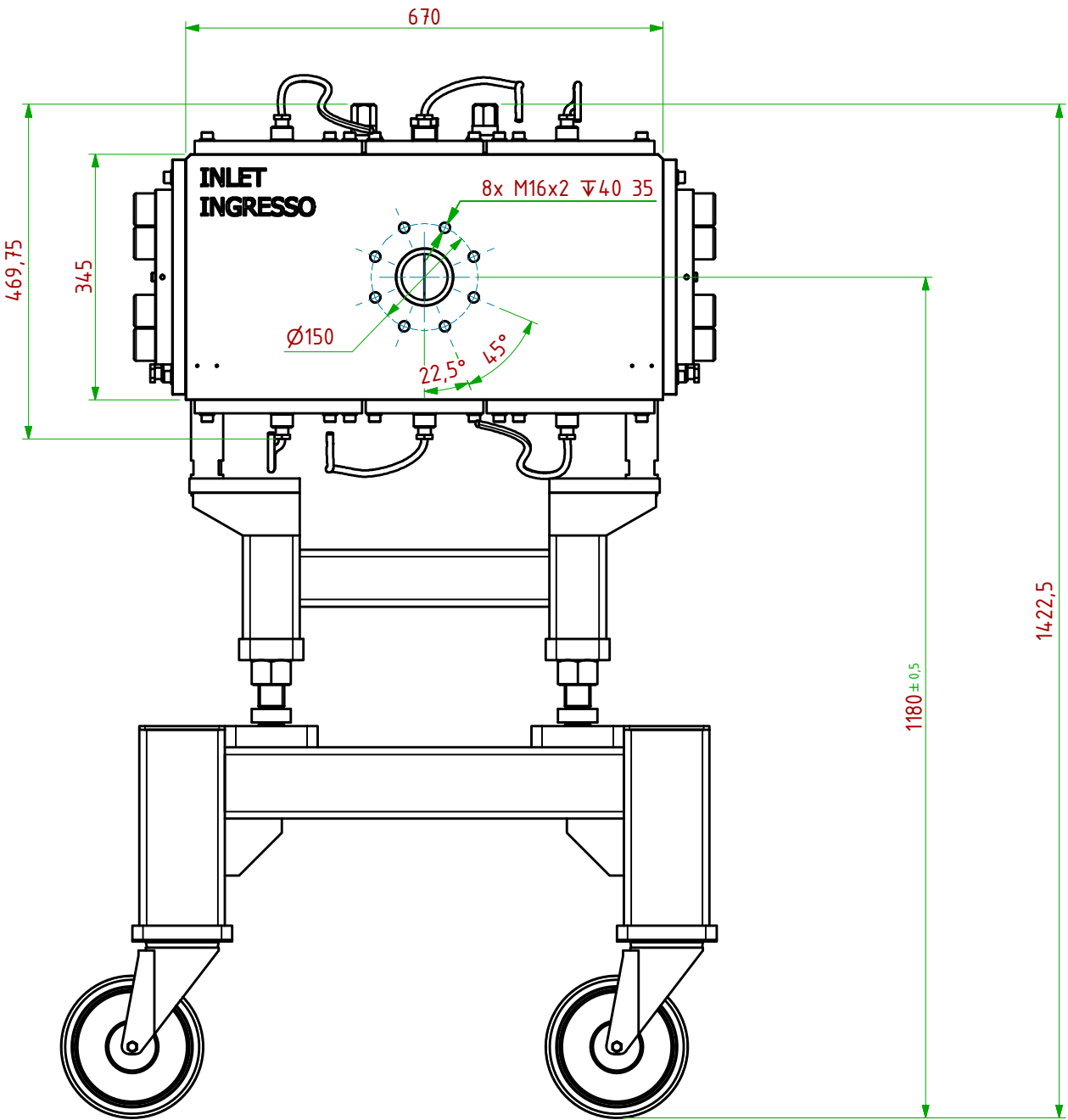

Electrical heaters type	Flat heaters	
Electrical connection	Armored cable	Lenght: 5 m
Voltage	230 V \pm 5% AC 1 PH.+PE	
Electrical heaters position	Dimension	Power [Watt]
Upper Left	235x545	6000 W
Upper Middle	165x545	4000 W
Upper Right	235x545	6000 W
Lower Left	235x545	6000 W
Lower Middle	165x545	4000 W
Lower Right	235x545	6000 W
Lateral (2)	180x330	2 x 2800 W
Pressure control connection	not required	
Temperature control connection	1/4" G - Hole \u03a6 8.5x225 mm	

Smussi non quotati: 0.5X45\u00b0			Appr. :	Scala:
Raccordi non quotati:			Data dis.: 13/10/2017	
			Dis.: ademattei	
			Data prog.13/10/2017	
Materiale - Materiale	Note	Trattamento - Treatment	Prog.: ademattei	
Denominazione - description:			MODELLO NUMERO - MODEL NUMBER	
SELF CLEANING BACKFLUSH SCREENCHANGER			AP10-M23-0000-000-R01	
			NUMERO DI SERIE - SERIAL NUMBER	
Via J.F. Kennedy, 9 - 20023 CERRO MAGGIORE (MI) - ITALY Tel. +39 0331 93551 - Fax +39 0331 935591			AP10-M23-0000-000-R01_AS-AP10-COMP	

Il presente disegno \u00e8 di propriet\u00e0 della COFIT International S.r.l. a norma di legge \u00e8 vietata ogni riproduzione o comunicazione a terzi.